

**TSDOR 2017 CONSTRUCTION PROGRAM**

**BROWARD COUNTY**

SW 130th AVE (MELALEUCA RD)  
SW 127th AVE (APPALOOSA TRL)  
SW 128TH ST  
SW 130TH AVE  
SW 56th ST

PO NUMBER 16-0028

A DETAILED INDEX APPEARS ON THE  
KEY SHEET OF EACH COMPONENT

**INDEX OF ROADWAY PLANS**

SHEET NO.	SHEET DESCRIPTION
1	KEYSHEET
2	SUMMARY OF PAY ITEMS
3 -5	TYPICAL SECTIONS
6 -6A	GENERAL NOTES/DRAINAGE STRUCTURES
7-20	PLANS
21-48	CROSS SECTIONS
49-50	SWPPP

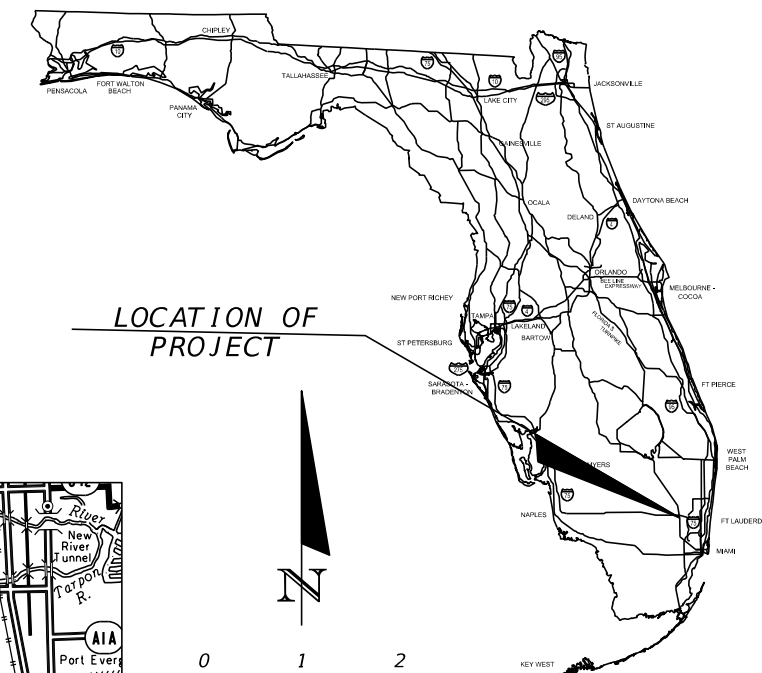

LOCATION OF PROJECT

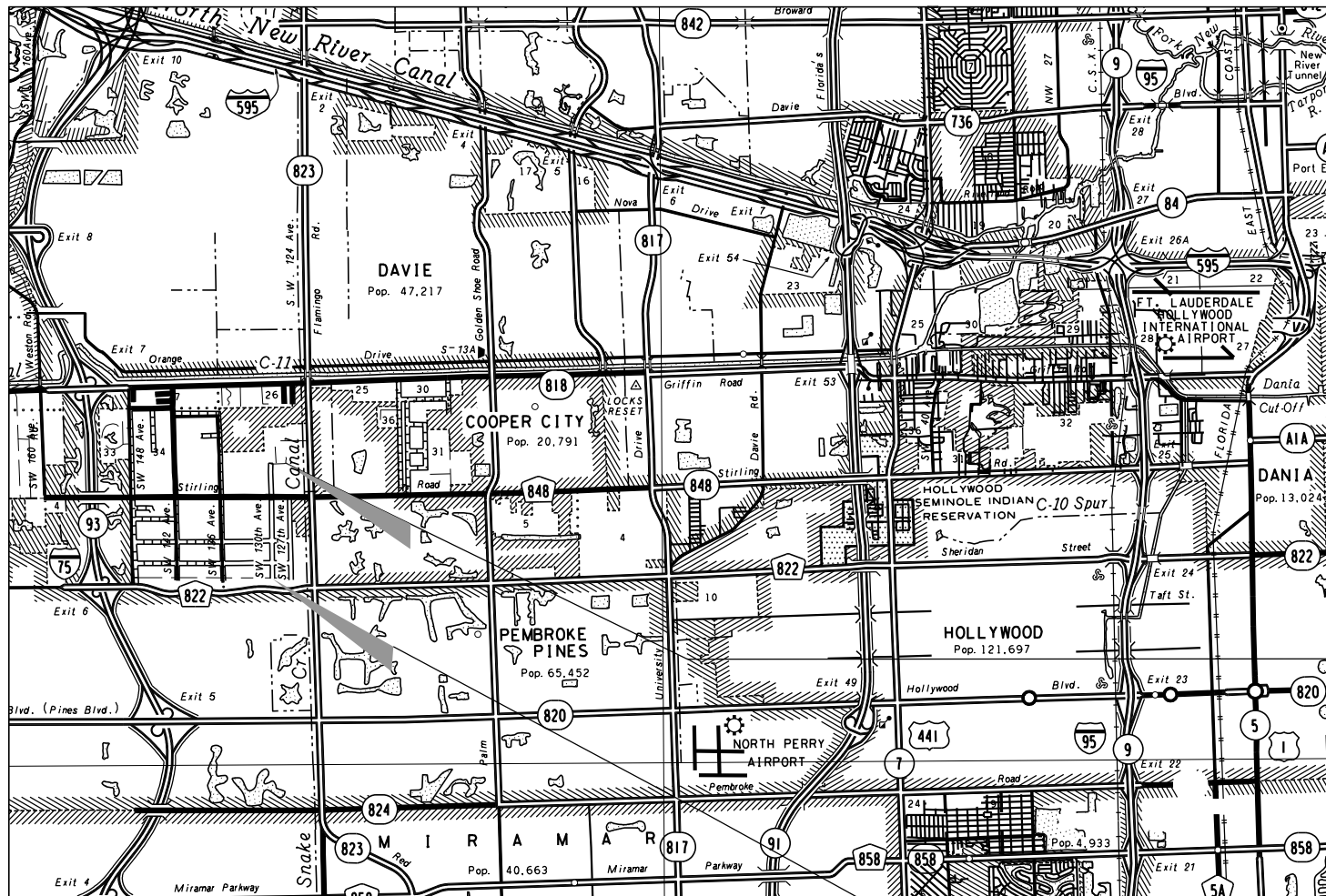
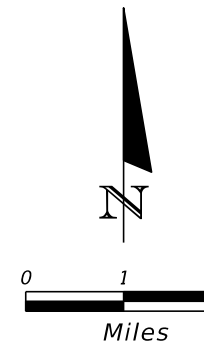

TOWN OF SOUTHWEST RANCHES

**COUNCIL**

DOUG McKAY  
(MAYOR)

STEVE BREITKREUZ  
(VICE MAYOR)

DENISE SCHROEDER  
(COUNCIL MEMBER)

GARY JABLONSKI  
(COUNCIL MEMBER)

FREDDY FISKELLI  
(COUNCIL MEMBER)

GOVERNING STANDARDS AND SPECIFICATIONS:  
Florida Department of Transportation, 2016 Design Standards and revised Index Drawings as appended herein, and 2015 Standard Specifications for Road and Bridge Construction, as amended by Contract Documents.

For Design Standards click on the "Design Standards" link at the following web site:  
<http://www.dot.state.fl.us/rddesign/>

For the Standard Specifications for Road and Bridge Construction click on the "Specifications" link at the following web site:  
<http://www.dot.state.fl.us/specificationsoffice/>

NOTE: LENGTH OF PROJECT IS BASED ON THE BASELINE CONSTRUCTION STATIONING

LENGTH OF PROJECT		
	LINEAR FEET	MILES
ROADWAY	15,547.60	3.030
BRIDGES	0.00	0.000
NET LENGTH OF PROJECT	15,547.60	3.030
EXCEPTIONS	0.00	0.000
GROSS LENGTH OF PROJECT	15,547.60	3.030

BEGIN PROJECT

KEY SHEET REVISIONS	
DATE	DESCRIPTION
03/08/2017	Pre-Bid Revision

END PROJECT

ROADWAY SHOP DRAWINGS TO BE SUBMITTED TO:

ERDMAN ANTHONY OF FLORIDA, INC.  
5405 OKEECHOBEE BLVD., SUITE 200  
WEST PALM BEACH, FL. 33417  
561-753-9723

PLANS PREPARED BY:

ERDMAN ANTHONY OF FLORIDA, INC.  
5405 OKEECHOBEE BLVD., SUITE 200  
WEST PALM BEACH, FL. 33417  
561-753-9723

VENDOR NO. 20-0930234  
CERTIFICATE OF AUTHORIZATION #25912



NOTE: THE SCALE OF THESE PLANS MAY HAVE CHANGED DUE TO REPRODUCTION.

DESIGN CRITERIA :  
MANUAL OF UNIFORM MINIMUM STANDARD FOR DESIGN, CONSTRUCTION, AND MAINTENANCE FOR STREETS AND HIGHWAYS (FLORIDA GREENBOOK) DATED MAY 2011.

FEDERAL HIGHWAY ADMINISTRATION  
MANUAL ON UNIFORM TRAFFIC CONTROL DEVICES  
DATED 5/2009 WITH REVISIONS 1 & 2

ROADWAY PLANS  
ENGINEER OF RECORD: JAMES F. NOTH, P.E.

P.E. NO.: 32652

TOWN OF SOUTHWEST RANCHES PROJECT MANAGER: ROD LEY, P.E., LEED AP, CPEEC

FISCAL YEAR	SHEET NO.
17	1

**BASE BID (SOUTH OF STIRLING)**

ITEM DESCRIPTION		UNITS	Appaloosa Trail	Melaleuca (south)	QUANTITY TOTALS
			SW 127th Ave.	SW 130th Ave.	
101-1	MOBILIZATION	LS	-	-	1
102-1	MAINTENANCE OF TRAFFIC	LS	-	-	1
104-10-3	SEDIMENT BARRIER	LF	10450	10410	20,860
327-70-1	MILLING (1")	SY	12435	12565	25,000
110-1-1	CLEARING AND GRUBBING	LS	-	-	1
120-1	REGULAR EXCAVATION (swale grading)	LF	1180	3437	4,617
160-4	TYPE B STABILIZATION (Reconstruction)	SY	N/A	N/A	N/A
285-706	OPTIONAL BASE GROUP 6 (Reconstruction)	SY	N/A	N/A	N/A
285-709	OPTIONAL BASE GROUP 9 (widening and pavement repairs)	SY	N/A	48	48
334-1-13	SUPERPAVE ASPHALTIC CONCRETE, TRAFFIC C (1" resurfacing)	TN	678.9	645.8	1324.7
334-1-13	SUPERPAVE ASPHALTIC CONCRETE, TRAFFIC C (Reconstruction)	TN	N/A	N/A	N/A
570-1-2	PERFORMANCE TURF, SOD (swales)	SY	1940	1930	3,870
<b>DRAINAGE STRUCTURES</b>					
0425 1541	INLETS, DT BOT, TYPE D, <10'	EA	5	5	10
430 175 118	18 " CONCRETE PIPE	LF	0	45	45
430 175 124	24 " CONCRETE PIPE	LF	177	130	307
<b>SIGNING AND PAVEMENT MARKINGS</b>					
700-1-11	SINGLE POST SIGN, F&I GROUND MOUNT, UP TO 12 SF	AS	N/A	N/A	N/A
710-11-111	PAINTED PAVEMENT MARKINGS, STANDARD, WHITE, SOLID,6"	LF	265	N/A	265
711-11-125	PAINTED PAVEMENT MARKINGS, STANDARD, WHITE, SOLID,24"	LF	120	115	235
710-11-211	PAINTED PAVEMENT MARKINGS, STANDARD, YELLOW, SOLID,6"	LF	40	1000	1040

**BID ALTERNATE (NORTH OF STIRLING)**

ITEM DESCRIPTION		UNITS	Melaleuca (north)	SW 56th Street	SW 128Th Ave.	SW 130th Ave	QUANTITY TOTALS
			SW 130th Ave.			East	
101-1	MOBILIZATION	LS	-	-	-	-	1
102-1	MAINTENANCE OF TRAFFIC	LS	-	-	-	-	1
104-10-3	SEDIMENT BARRIER	LF	4480	2700	2400	660	10240
327-70-1	MILLING (1")	SY	5270	N/A	N/A	N/A	5270
110-1-1	CLEARING AND GRUBBING	LS	-	-	-	-	1
120-1	REGULAR EXCAVATION (swale grading)	LF	N/A	N/A	N/A	N/A	N/A
160-4	TYPE B STABILIZATION (Reconstruction)	SY	N/A	2500	2380	735	5615
285-706	OPTIONAL BASE GROUP 6 (Reconstruction)	SY	N/A	2500	2380	735	5615
285-709	OPTIONAL BASE GROUP 9 (widening and pavement repairs)	SY	14	N/A	N/A	N/A	14
334-1-13	SUPERPAVE ASPHALTIC CONCRETE, TRAFFIC C (1" resurfacing)	TN	288.9	N/A	N/A	N/A	288.9
334-1-13	SUPERPAVE ASPHALTIC CONCRETE, TRAFFIC C (Reconstruction)	TN	N/A	174.5	118.7	41.8	335
570-1-2	PERFORMANCE TURF, SOD (swales)	SY	N/A	N/A	N/A	N/A	N/A
<b>DRAINAGE STRUCTURES</b>							
0425 1541	INLETS, DT BOT, TYPE D, <10'	EA	3	2	N/A	N/A	5
430 175 118	18 " CONCRETE PIPE	LF	50	0	N/A	N/A	50
430 175 124	24 " CONCRETE PIPE	LF	90	23	N/A	N/A	113
<b>SIGNING AND PAVEMENT MARKINGS</b>							
700-1-11	SINGLE POST SIGN, F&I GROUND MOUNT, UP TO 12 SF	AS	N/A	1	1	1	3
710-11-111	PAINTED PAVEMENT MARKINGS, STANDARD, WHITE, SOLID,6"	LF	N/A	N/A	N/A	N/A	N/A
711-11-125	PAINTED PAVEMENT MARKINGS, STANDARD, WHITE, SOLID,24"	LF	10	N/A	N/A	N/A	10
710-11-211	PAINTED PAVEMENT MARKINGS, STANDARD, YELLOW, SOLID,6"	LF	100	N/A	N/A	N/A	100

REVISIONS			
DATE	DESCRIPTION	DATE	DESCRIPTION
03/08/2017	PRE-BID REVISION		

**ERDMAN ANTHONY**  PHONE 561-753-9723  
 ERDMAN ANTHONY OF FLORIDA, INC.  
 JAMES F. NOTH, P.E. P.E. LICENSE NUMBER 32652  
 5405 OKEECHOBEE BLVD., SUITE 200  
 WEST PALM BEACH, FL 33417  
 CERTIFICATE OF AUTHORIZATION 25912

**TOWN OF SOUTHWEST RANCHES**  
 ROAD NAME

**SUMMARY OF PAY ITEMS/**

THE OFFICIAL RECORD OF THIS SHEET IS THE ELECTRONIC FILE DIGITALLY SIGNED AND SEALED UNDER RULE 61G15-23.004, F.A.C.

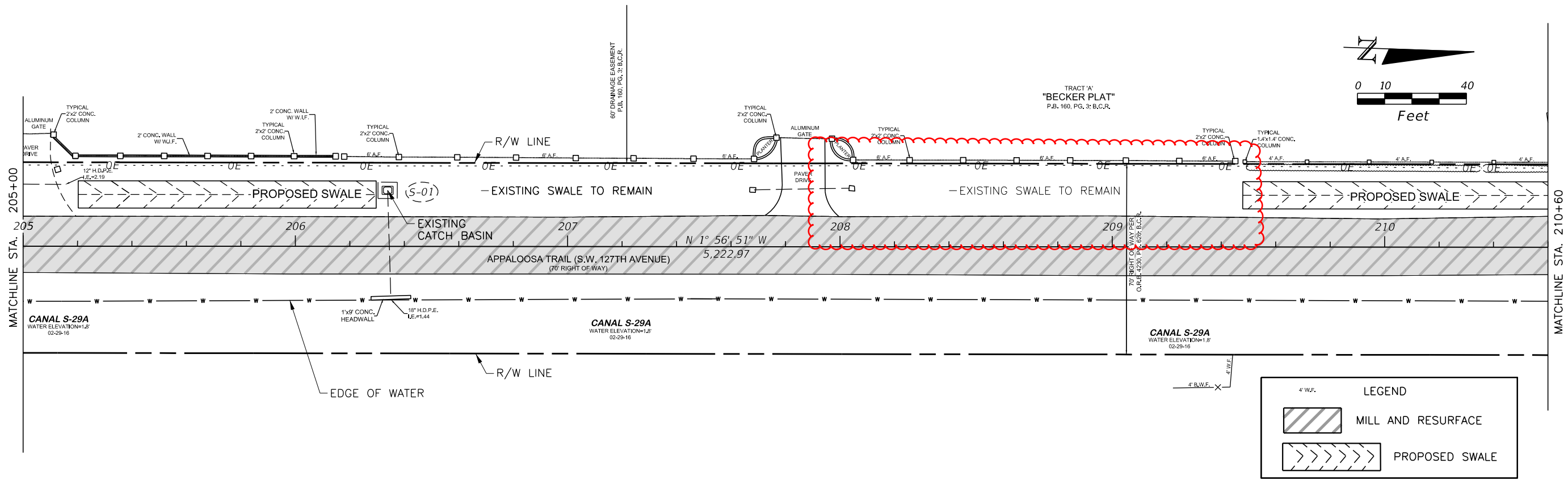
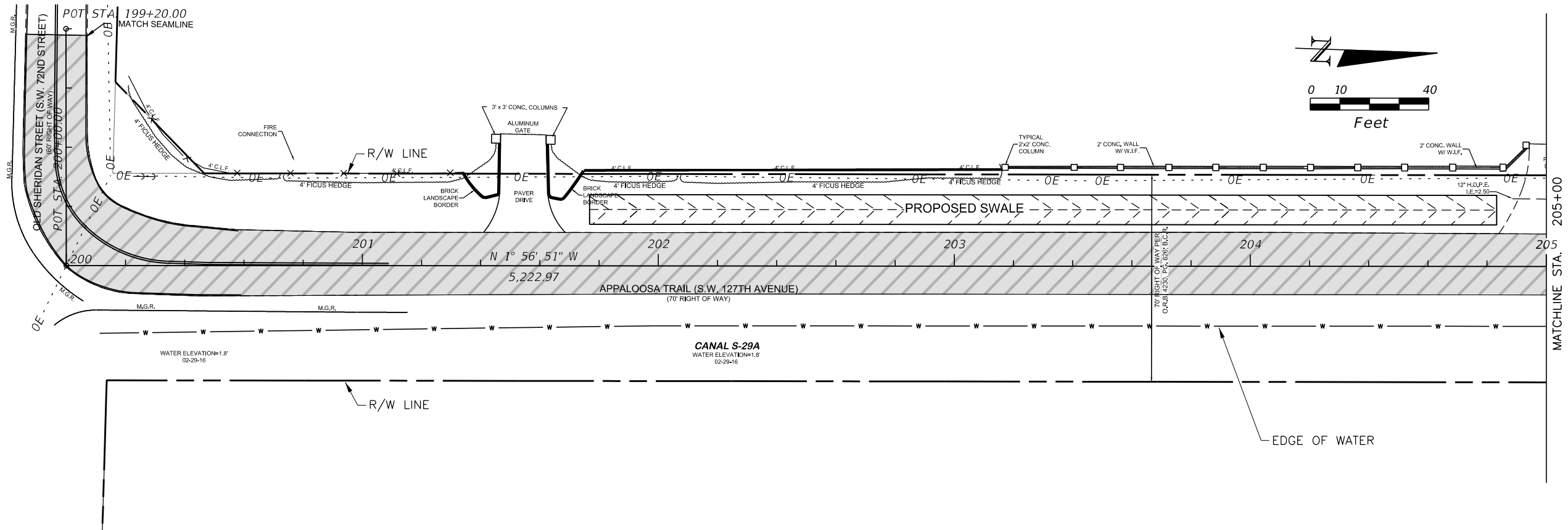

REVISIONS			
DATE	DESCRIPTION	DATE	DESCRIPTION
03/08/2017	SWALE GRADING REMOVED		

**ERDMAN ANTHONY**  PHONE 561-753-9723  
 ERDMAN ANTHONY OF FLORIDA, INC.  
 JAMES F. NOTH, P.E. P.E. LICENSE NUMBER 32652  
 5405 OKEECHOBEE BLVD., SUITE 200  
 WEST PALM BEACH, FL 33417  
 CERTIFICATE OF AUTHORIZATION 25912

TOWN OF  
**SOUTHWEST RANCHES**  
 ROAD NAME  
**APPALOOSA TRAIL (S.W. 127TH AVENUE)**

**PLAN**  
 SHEET NO.  
**14**

THE OFFICIAL RECORD OF THIS SHEET IS THE ELECTRONIC FILE DIGITALLY SIGNED AND SEALED UNDER RULE 61G15-23.004, F.A.C.

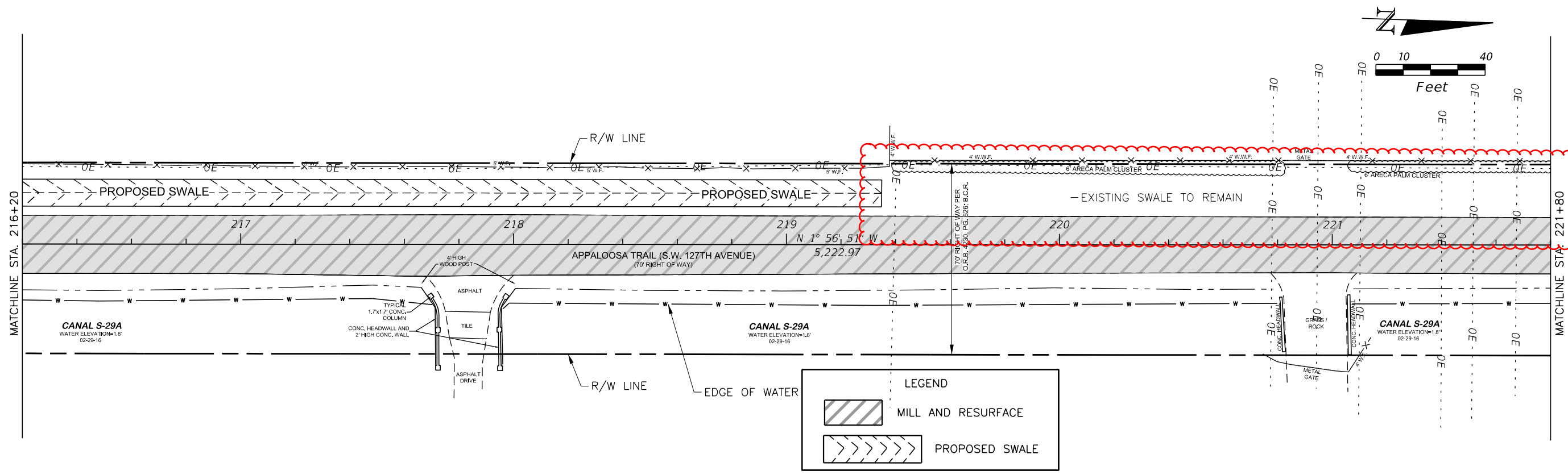
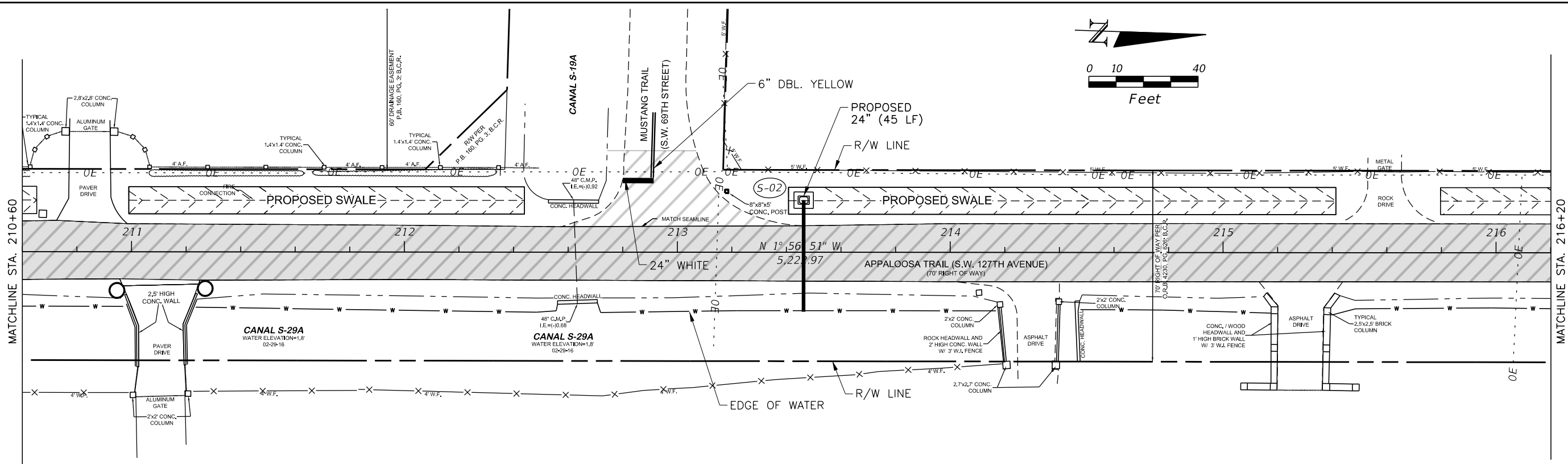

**LEGEND**

- MILL AND RESURFACE
- PROPOSED SWALE

REVISIONS			
DATE	DESCRIPTION	DATE	DESCRIPTION
03/08/2017	SWALE GRADING REMOVED		

**ERDMAN ANTHONY** PHONE 561-753-9723  
 ERDMAN ANTHONY OF FLORIDA, INC.  
 JAMES F. NOTH, P.E. P.E. LICENSE NUMBER 32652  
 5405 OKEECHOBEE BLVD., SUITE 200  
 WEST PALM BEACH, FL 33417  
 CERTIFICATE OF AUTHORIZATION 25912

**TOWN OF SOUTHWEST RANCHES**  
 ROAD NAME  
**APPALOOSA TRAIL (S.W. 127TH AVENUE)**

**PLAN**

SHEET NO.  
**15**

THE OFFICIAL RECORD OF THIS SHEET IS THE ELECTRONIC FILE DIGITALLY SIGNED AND SEALED UNDER RULE 61G15-23.004, F.A.C.

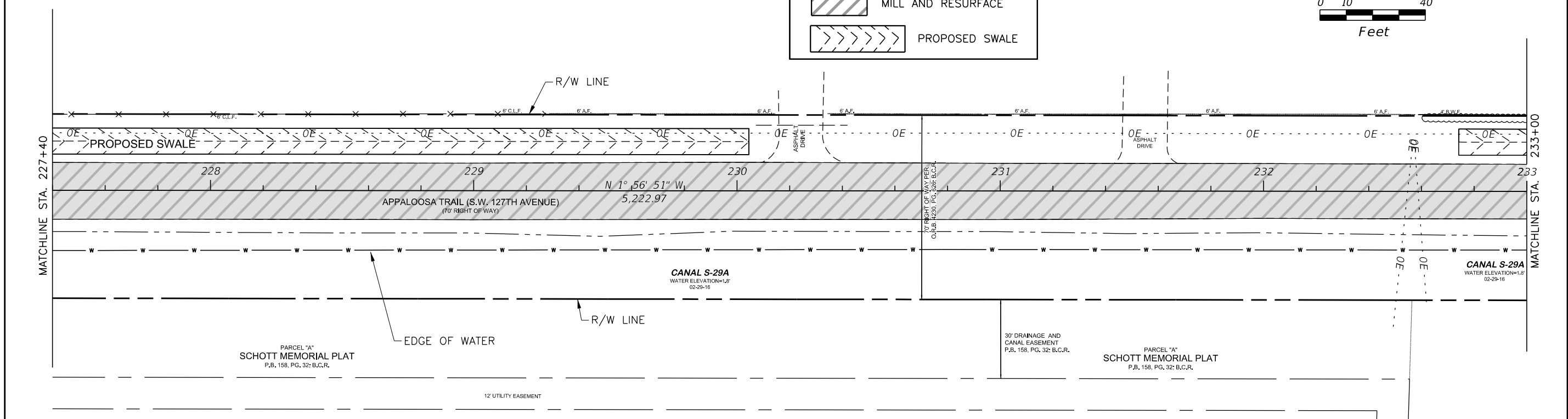
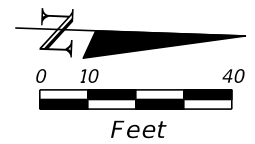
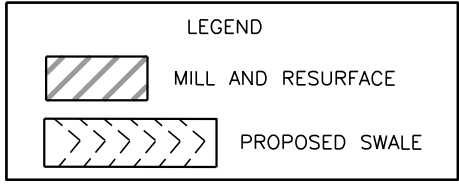
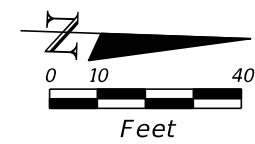
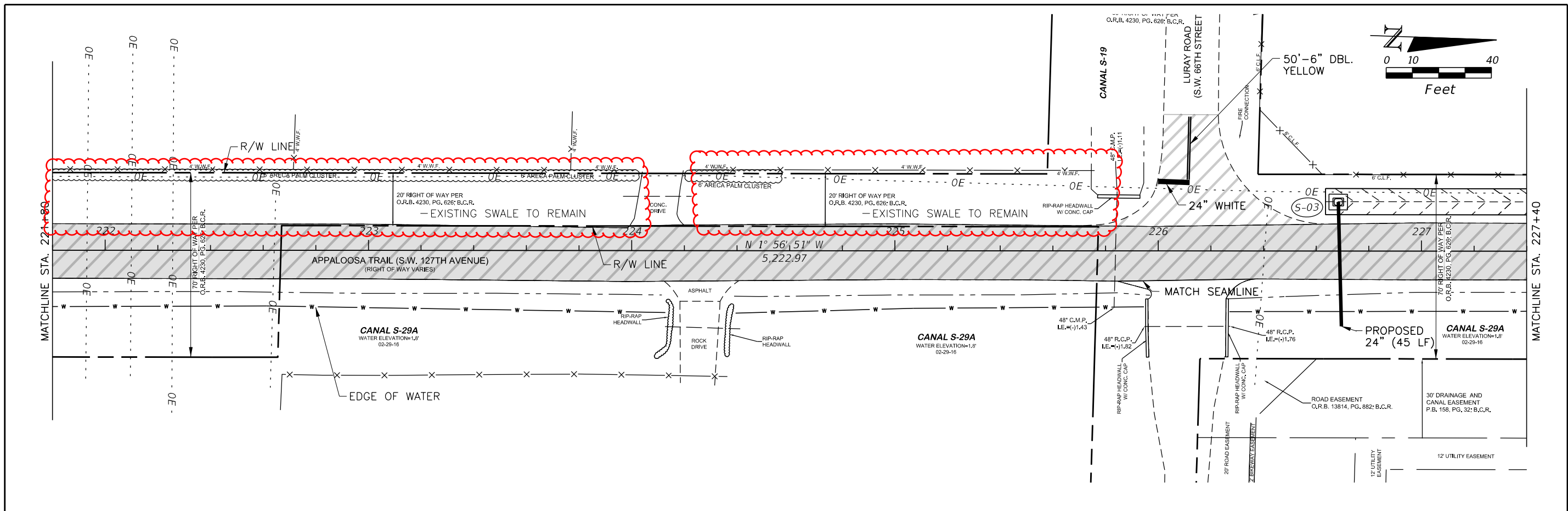

REVISIONS				<b>ERDMAN ANTHONY</b> ERDMAN ANTHONY OF FLORIDA, INC. JAMES F. NOTH, P.E. P.E. LICENSE NUMBER 32652 5405 OKEECHOBEE BLVD., SUITE 200 WEST PALM BEACH, FL 33417 CERTIFICATE OF AUTHORIZATION 25912 PHONE 561-753-9723	<b>TOWN OF SOUTHWEST RANCHES</b> ROAD NAME <b>APPALOOSA TRAIL (S.W. 127TH AVENUE)</b>	<b>PLAN</b>	SHEET NO. <b>16</b>
DATE	DESCRIPTION	DATE	DESCRIPTION				
03/08/2017	SWALE GRADING REMOVED						

THE OFFICIAL RECORD OF THIS SHEET IS THE ELECTRONIC FILE DIGITALLY SIGNED AND SEALED UNDER RULE 61G15-23.004, F.A.C.

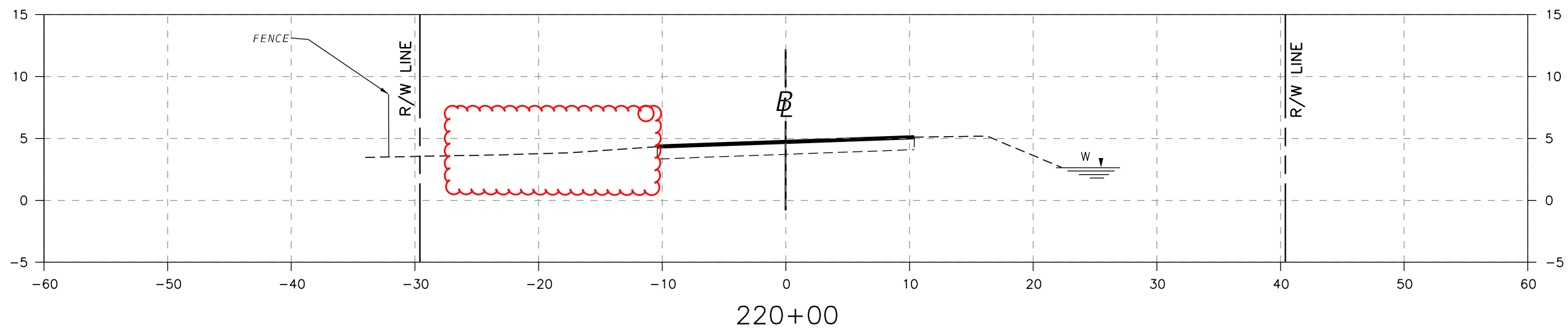
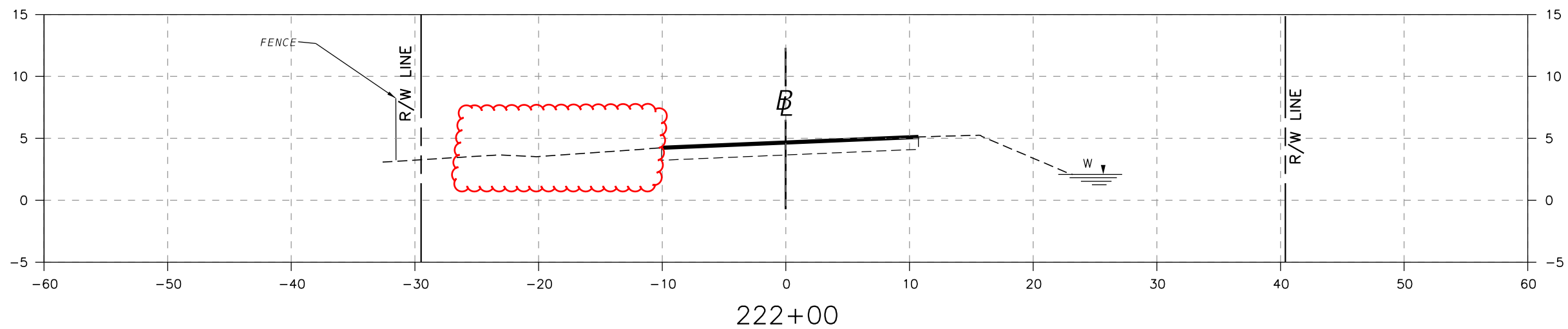
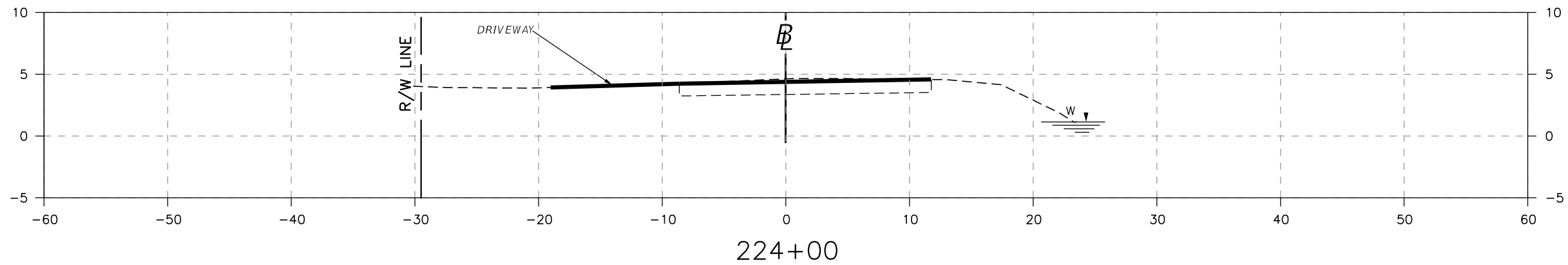

THE OFFICIAL RECORD OF THIS SHEET IS THE ELECTRONIC FILE DIGITALLY SIGNED AND SEALED UNDER RULE 61G15-23.004, F.A.C.

REVISIONS				ERDMAN ANTHONY		TOWN OF SOUTHWEST RANCHES		SHEET NO.	
DATE	DESCRIPTION	DATE	DESCRIPTION	PHONE 561-753-9723		ROAD NAME			
03/08/2017	SWALE GRADING REMOVED			ERDMAN ANTHONY OF FLORIDA, INC. JAMES F. NOTH, P.E. P.E. LICENSE NUMBER 32652 5405 OKEECHOBEE BLVD., SUITE 200 WEST PALM BEACH, FL 33417 CERTIFICATE OF AUTHORIZATION 25912		APPALOOSA TRAIL (S.W. 127TH AVENUE)		<b>CROSS SECTIONS</b>	

SUSERS SDATES STIMES SFILES

TOWN OF SOUTHWEST RANCHES, FLORIDA  
TSDOR 2017 Roadway Improvements  
IFB No. 17-00x

**BIDDER:** \_\_\_\_\_

**BID AND PROPOSAL FORM**

BASE BID (SOUTH OF STIRLING) page 1 of 2							
ITEM DESCRIPTION		UNITS	Appaloosa Trail /	Melaleuca (south) /	QUANTITY TOTALS	Unit Cost	COST
			SW 127th Ave.	SW 130th Ave.			
101-1*	MOBILIZATION	LS	-	-	1		
102-1	MAINTENANCE OF TRAFFIC	LS	-	-	1		
104-10-3	SEDIMENT BARRIER	LF	10450	10410	20,860		
110-1-1	CLEARING AND GRUBBING	LS	-	-	1		
120-1	REGULAR EXCAVATION (swale grading)	LF	1180	3437	4,617		
160-4	TYPE B STABILIZATION (Reconstruction)	SY	N/A	N/A	N/A	N/A	N/A
285-706	OPTIONAL BASE GROUP 6 (Reconstruction)	SY	N/A	N/A	N/A	N/A	N/A
285-709	OPTIONAL BASE GROUP 9 (widening and pavement repairs)	SY	N/A	48	48		
327-70-1	MILLING (1")	SY	12435	12565	25,000		
334-1-13	SUPERPAVE ASPHALTIC CONCRETE, TRAFFIC C (1" resurfacing)	TN	678.9	645.8	1324.7		
334-1-13	SUPERPAVE ASPHALTIC CONCRETE, TRAFFIC C (Reconstruction)	TN	N/A	N/A	N/A	N/A	N/A
570-1-2	PERFORMANCE TURF, SOD (swales)	SY	1940	1930	3,870		
DRAINAGE STRUCTURES							
0425 1541	INLETS, DT BOT, TYPE D, <10'	EA	5	5	10		
430 175 118	18 " CONCRETE PIPE	LF	0	45	45		
430 175 124	24 " CONCRETE PIPE	LF	177	130	307		

TOWN OF SOUTHWEST RANCHES, FLORIDA  
TSDOR 2017 Roadway Improvements  
IFB No. 17-00x

BASE BID (SOUTH OF STIRLING) page 2 of 2							
ITEM DESCRIPTION	UNITS	Appaloosa Trail /	Melaleuca (south) /	QUANTITY TOTALS	Unit Cost	COST	
		SW 127th Ave.	SW 130th Ave.				
SIGNING AND PAVEMENT MARKINGS							
700-1-11	SINGLE POST SIGN, F&I GROUND MOUNT, UP TO 12 SF	AS	N/A	N/A	N/A	N/A	N/A
710-11-111	PAINTED PAVEMENT MARKINGS, STANDARD, WHITE, SOLID,6"	LF	265	N/A	265		
711-11-125	PAINTED PAVEMENT MARKINGS, STANDARD, WHITE, SOLID,24"	LF	120	115	235		
710-11-211	PAINTED PAVEMENT MARKINGS, STANDARD, YELLOW, SOLID,6"	LF	40	1000	1040		
<b>BASE BID PRICE TOTAL</b>							

\*Pay Item 101-1 includes incidental cost such as Testing, Surveying, and other items needed to complete the project.



TOWN OF SOUTHWEST RANCHES, FLORIDA  
TSDOR 2017 Roadway Improvements  
IFB No. 17-00x

**BIDDER:** \_\_\_\_\_

**BID AND PROPOSAL FORM**

BID ALTERNATE (NORTH OF STIRLING) page 1 of 2									
ITEM DESCRIPTION		UNITS	Melaleuca (north) /	SW 56th Street	SW 128Th Ave.	SW 130th Ave	QUANTITY TOTALS	Unit Cost	COST
			SW 130th Ave.			East			
101-1*	MOBILIZATION	LS	-	-	-	-	1		
102-1	MAINTENANCE OF TRAFFIC	LS	-	-	-	-	1		
104-10-3	SEDIMENT BARRIER	LF	4480	2700	2400	660	10240		
110-1-1	CLEARING AND GRUBBING	LS	-	-	-	-	1		
120-1	REGULAR EXCAVATION (swale grading)	LF	N/A	N/A	N/A	N/A	N/A	N/A	N/A
160-4	TYPE B STABILIZATION (Reconstruction)	SY	N/A	2500	2380	735	5615		
285-706	OPTIONAL BASE GROUP 6 (Reconstruction)	SY	N/A	2500	2380	735	5615		
285-709	OPTIONAL BASE GROUP 9 (widening and pavement repairs)	SY	14	N/A	N/A	N/A	14		
327-70-1	MILLING (1")	SY	5270	N/A	N/A	N/A	5270		
334-1-13	SUPERPAVE ASPHALTIC CONCRETE, TRAFFIC C (1" resurfacing)	TN	288.9	N/A	N/A	N/A	288.9		
334-1-13	SUPERPAVE ASPHALTIC CONCRETE, TRAFFIC C (Reconstruction)	TN	N/A	174.5	118.7	41.8	335		
570-1-2	PERFORMANCE TURF, SOD (swales)	SY	N/A	N/A	N/A	N/A	N/A	N/A	N/A
<b>DRAINAGE STRUCTURES</b>									
0425 1541	INLETS, DT BOT, TYPE D, <10'	EA	3	2	N/A	N/A	5		
430 175 118	18" CONCRETE PIPE	LF	50	0	N/A	N/A	50		
430 175 124	24" CONCRETE PIPE	LF	90	23	N/A	N/A	113		

TOWN OF SOUTHWEST RANCHES, FLORIDA  
TSDOR 2017 Roadway Improvements  
IFB No. 17-00x

BID ALTERNATE (NORTH OF STIRLING) page 2 of 2									
ITEM DESCRIPTION	UNITS	Melaleuca (north) /	SW 56th Street	SW 128Th Ave.	SW 130th Ave	QUANTITY TOTALS	Unit Cost	COST	
		SW 130th Ave.			East				
SIGNING AND PAVEMENT MARKINGS									
700-1-11	SINGLE POST SIGN, F&I GROUND MOUNT, UP TO 12 SF	AS	N/A	1	1	1	3		
710-11-111	PAINTED PAVEMENT MARKINGS, STANDARD, WHITE, SOLID,6"	LF	N/A	N/A	N/A	N/A	N/A	N/A	N/A
711-11-125	PAINTED PAVEMENT MARKINGS, STANDARD, WHITE, SOLID,24"	LF	10	N/A	N/A	N/A	10		
710-11-211	PAINTED PAVEMENT MARKINGS, STANDARD, YELLOW, SOLID,6"	LF	100	N/A	N/A	N/A	100		
BID ALTERNATE PRICE TOTAL									

\*Pay Item 101-1 includes incidental cost such as Testing, Surveying, and other items needed to complete the project.